



---

## 5-0 IGNITE RB – QUEST 125A ALTERNATOR V2 INSTALLATION GUIDE

---

This installation guide is applicable to the following vehicle make and models;

- Nissan Skyline (ALL MODELS) – SKU# 50IGNRBQUEST125AV2

Engine: RB20DET / RB25DET / RB26DETT / RB30 DOHC VARIANTS

- RB30 SOHC REQUIRES DOHC CRANK PULLEY TO USE WITH MULTI RIBBED BELT



**Please read this installation guide carefully prior to installing the product.**

---

### LIABILITY DISCLAIMER

---

Products provided by 5-0 Ignite may not comply with the legal requirements for public road vehicles in your country/state/territory. Therefore, all products are intended for racing or off-road use exclusively. 5-0 Ignite, along with its officers, directors, and employees, shall not be held liable for any incidental or consequential damages to property, vehicles, vehicle components or equipment, loss of property, vehicles, vehicle components or equipment, loss of profit or revenue, injury, or death, whether directly or indirectly related to the use and/or installation of any products supplied by 5-0 Ignite. 5-0 Ignite shall not be held responsible for any labour costs to fit or remove of any the product(s) supplied with or without relation to warranty.

5-0 Ignite will only respond to queries with its direct customers that have purchased the product(s) in regard to all matters unless otherwise agreed, such as involving 3rd party queries in such situations where technical assistance is required. All ECU-related settings must be addressed to your tuner or ECU manufacturer representative/ technical support.

If in doubt, seek professional help.

For further information, visit [www.50ignite.com/terms-and-conditions/](http://www.50ignite.com/terms-and-conditions/)

---

## INTRODUCTION

---

Thank you for purchasing 5-0 Ignite RB to Nissan Quest 125A alternator conversion kit V2. We have done all the hard work to ensure that your installation is a breeze and clean. Your kit should include the following items;

- 1x Billet aluminium upper mounting adapter
- 1x M10x1.25 Class 8.8 bolt (replacement alternator long main bolt)
- 1x M10x1.25 Class 8 flanged nut (not used if you are re-using the OEM nut)
- 1x M10 washer
- 1x M8x1.25 Class 8.8 socket head cap bolt
- 1x M8 dress up washer
- 1x Pulley

Installation time is typically 40 mins, depending on your engine setup, requiring basic set of mechanical skills and hand tools.

---

## INFORMATION AND LIMITATIONS

---

- This installation guide covers the aspects of adapting the Nissan Quest 125A alternator onto your RB engine utilising the 5-0 Ignite conversion kit. **Refer to FSM on how to remove/replace your alternator or seek a qualified mechanic.**
- **Alternator is NOT supplied – Mounting Kit Only.** We use and recommend the following aftermarket Nissan Quest alternator to ensure correct fitment without further modifications and can be easily purchased online elsewhere at better deal;

Brand: TYC

Part No.: 2-13821 (brand new aftermarket unit, not refurbished)

OEM Part No.: 231007B000R (1999-2002 Nissan Quest VG33E)

- **Components from OEM RB alternator that are required to be transferred** to the Nissan Quest alternator:
  - Split pin (optional, alternatively the split pin on the quest alternator can be drilled out)
  - Main bolt retaining nut (optional)
  - Main bolt spacer round bar
- Belt to use: 4PK880 Micro-V (RB26) or 4PK860 Micro-V (RB20/25) - may vary slightly if you're using aftermarket crank pulley and/or water pump pulley.

---

## PROCEDURE

---

1. Disconnect/remove battery.
2. Disconnect wiring harness, remove belt and remove your existing alternator.
3. Knock out and transfer the split pin from your OEM RB alternator to the Nissan Quest unit (figure 2). Alternatively, you may drill the split pin that came with the Nissan Quest alternator to 10mm diameter.
4. Drill the Nissan Quest alternator mounting hole to 10mm diameter (figure 2).
5. Install the supplied pulley. Impact wrench allows the removal and tightening of the pulley nut easier.
6. Mount the Nissan Quest alternator to your engine, re-use the components shown in figure 1.
7. Install the supplied adapter onto the Nissan Quest alternator. Loctite the bolt thread and torque to ~27Nm (figure 3). **Note: You may require to loosen the two bolts on the alternator mounting bracket to the water pump for alignment.**

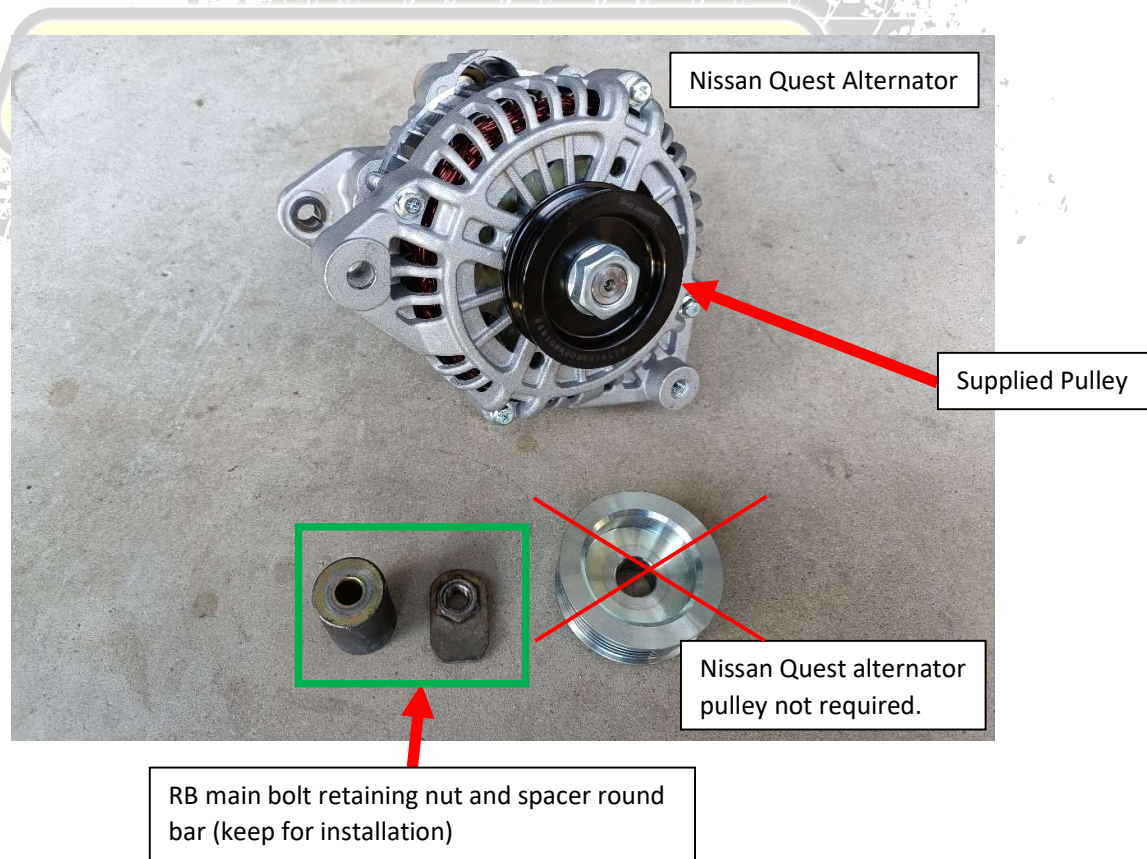

Figure 1 – Component Layout

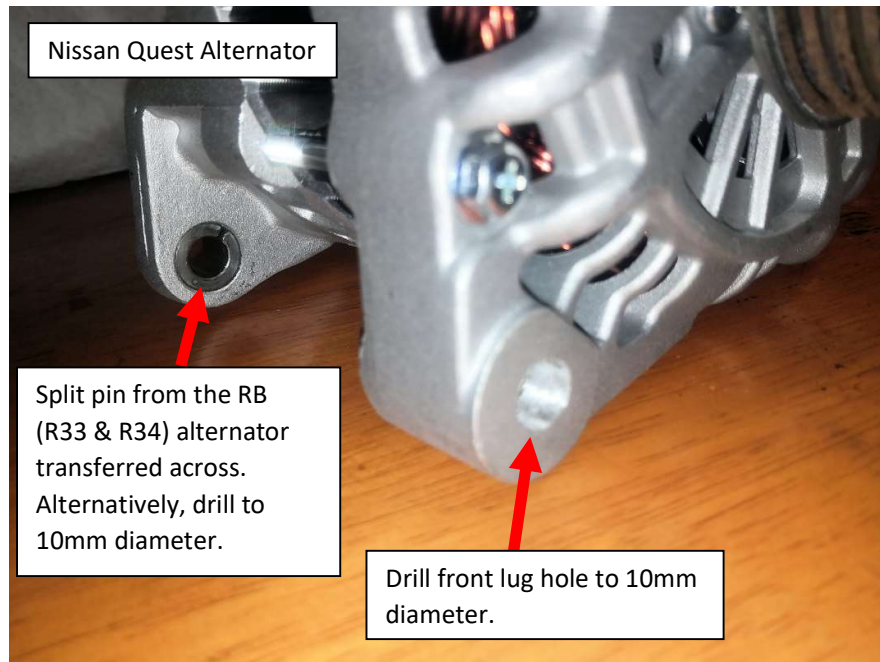

Figure 2 – Transfer OR Drill Split Pin and Drill Front Lug Hole

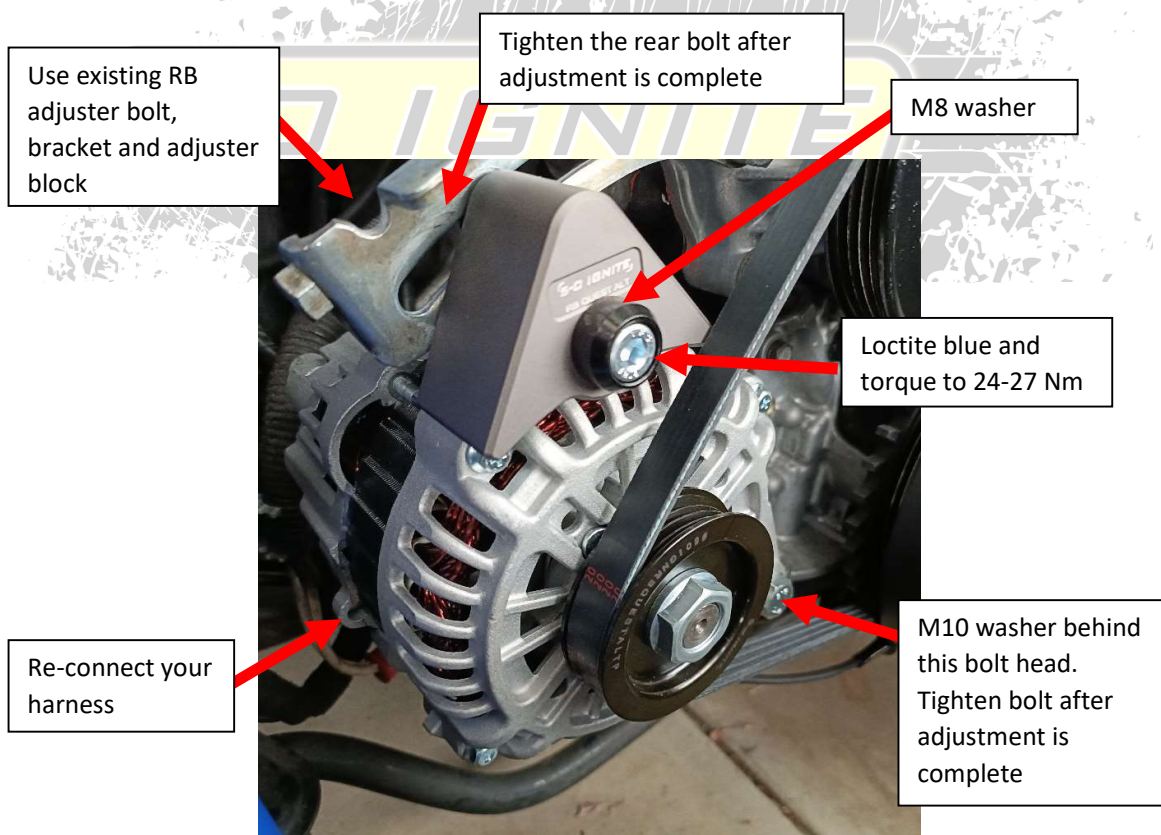

Figure 3 - Install the Alternator and the Mounting Adapter

**R32 SKYLINE / RB30 / S13 – SPECIAL INSTRUCTIONS**

- **Alternator Power (+) Positive Cable Terminal**

OEM terminal/lug on the R32/R31/VL Commodore/S13 is to suit M6 stud. This needs to be cut and re-crimped with a terminal/lug (commonly available from your local auto parts store) that suits 8mm stud.

8. Install and tension the drive belt. Tighten the alternator main mounting bolt and adjuster locking bolt.
9. Re-connect wiring harness (positive terminal, ground rings and the 2-pin connector).

---

**CONCLUSION**

---

Installation is now complete. Re-check all steps in the procedure, if all good, re-connect battery and start the engine. Ensure that voltage is above 13.7 V when the engine is running and the drive belt is sufficiently tensioned.

